



# DANPATHERM

Unitized Large-Spanning High  
Insulation System for Facades

[www.danpal.com](http://www.danpal.com)



FACADES



# **INOVATION**

The never ending search for better building materials that save energy and reduce the erection time has brought us the develop  
**DANPATHERM**

# INOVATION

**Saving energy**  
optimization of LT %  
and insulation

**Unitized system**  
reducing installation  
time and labor costs

# CONTENT

Description

System Benefits

Colors, finishes & additions

Application

Technical details

Standards & Certification

Projects References



# DESCRIPTION

## DANPATHERM

The DANPATHERM is an advanced Unitized System for translucent facades, offering:

1. High weather and load resistance
2. Optimal Light transmission and thermal insulation



# DESCRIPTION

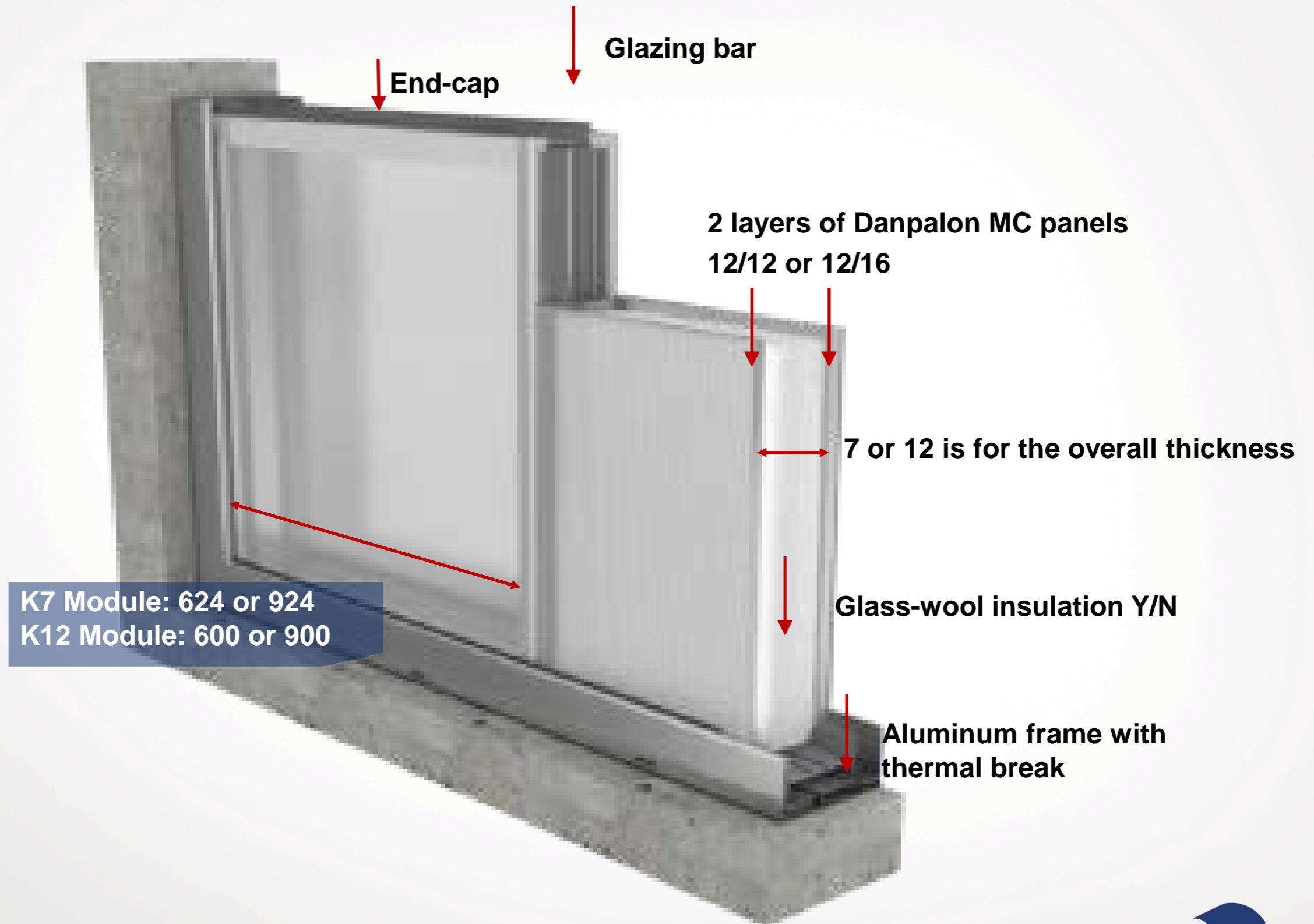

# SYSTEM BENEFITS

- Exceptional thermal insulation
- Superior protection against water and air infiltration
- Variable levels of light transmissions and color
- Clean look: uniform appearance, no visible aluminum
- Very high wind load resistance: long spanning
- Soft diffused light
- Skin replacement possibilities
- Factory Unitized cassette:
  - ✓ Fast and easy installation
  - ✓ Clean and safe installation

# TECHNICAL DETAILS

PRODUCT	DANPATHERM K7	DANPATHERM K12
Installation module	624mm, 924mm	600mm
Wall structure	12/12 or 12/16mm Polycarbonate panels w/wo insulation	12+12 mm polycarbonate panels with or without insulation
Structure	Honeycomb/multicell	Multicell
Wall thickness	70 mm	120 mm
Cassette length	Standard up to 8 metres	Standard 10.5 meter
U value (W/m <sup>2</sup> K) undisturbed panel	Minimum of 0.72	Minimum of 0.52
Light transmission cassette with insulation	Up to 30%	Up to 24%
Joining method between cassettes	Polycarbonate cover plus screw fixings	Concealed connections
Free span between supports	3 metres	4 metres
10 year warranty	Yes	Yes
Resistance to fire	B- s1, D0	B- s1, D0



# STANDARDS & CERTIFICATION

PROPERTY	STANDARD	RESULT
Acoustics [dB]	NF EN ISO 140-1((1997	26
Impact test	NF P 08-301((1991 NF P 08-302((1990	M50- pass
Fire test	EN 13501-1+A1: 2013	B-s1,do [K7, K[12
Water & air permeability	NF EN 12153 NF EN 12155	PASS
Technical agreement		CSTB Avis Technique

# PANEL SURFACE FINISH

## We Offer a Range of Panel Surface Finishes According to Environmental Conditions and Architectural Requirements

### **SOFTLITE** FOR VISUAL COMFORT

Softlite finishing greatly diminishes glare effects. Softlite is a 100% permanent matt finish applied by co-extrusion on Danpalon® panels of any thickness and colour. The Softlite finishing performance is independently validated to



### **LOW-E**

Infrared treatment is a co-extruded finish that can be applied in all panels. It can significantly limit solar heat gain without affecting light transmission levels.

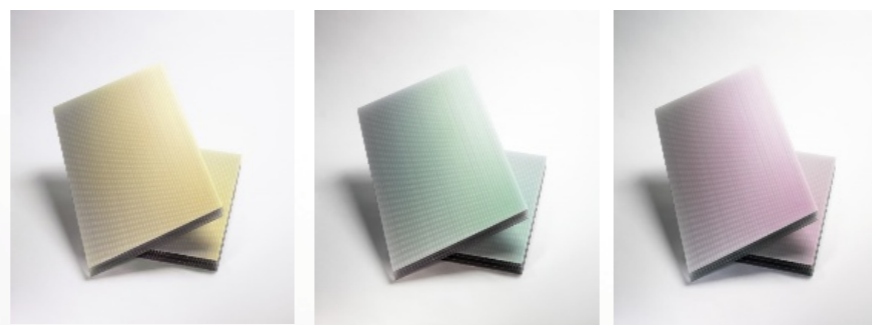

### **HP** HIGH PROTECTION TREATMENT

Danpalon® HP is an advanced surface treatment that enables higher performance in areas of graffiti removal and protection against environmental pollution.



# PANEL SURFACE FINISH

## BI-COLOR

Our bicolour option enables you to perfectly adapt your facades to the effect you desire, both inside and outside. It is available in the colours of your choice for all Danpal® systems

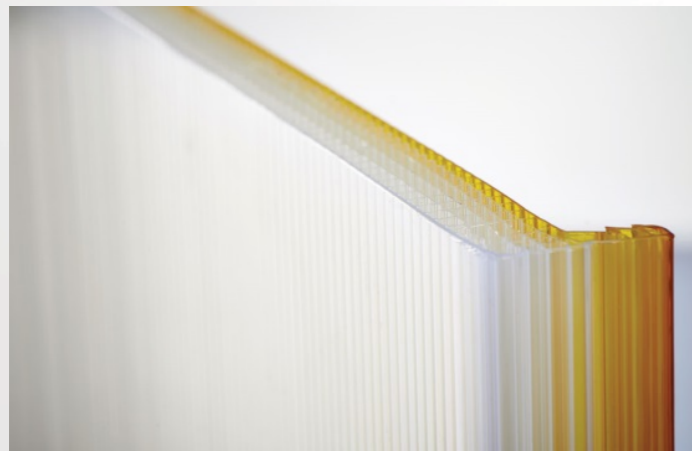

## OPAQUE AND TRANSLUCENT

For bright colours with a metallic, lacquered appearance, choose the opaque panels available in a wide range of tints. With Danpal's translucent range, the appearance of the building changes with the light and reflections projected onto the facade at different times of day.

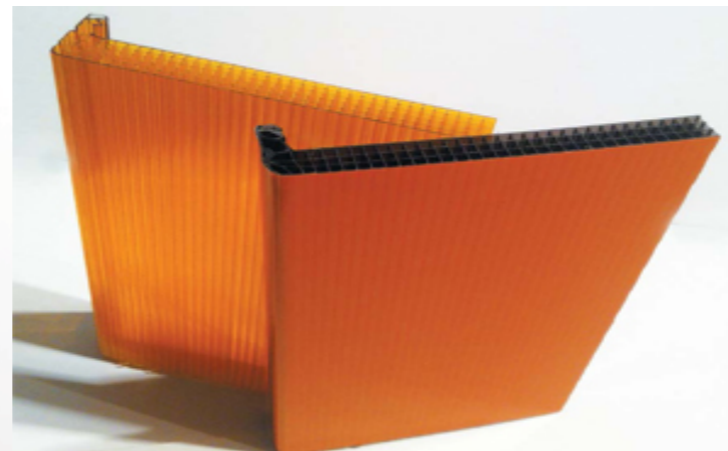

## INTERNAL LED LIGHTING

Artificial lighting for endless design possibilities at night



# VARIETY OF COLORS

<http://danpal.com/architects-inspiration/color/>



# APPLICATION



Sport centers



Industry



Education



Office



Commercial



Transportation

Designed to meet various types of buildings and application designs.

# PROJECTS REFERENCES

Logistic Center, Architect: Agence BLP - Brochet Lajus Pueyo, France

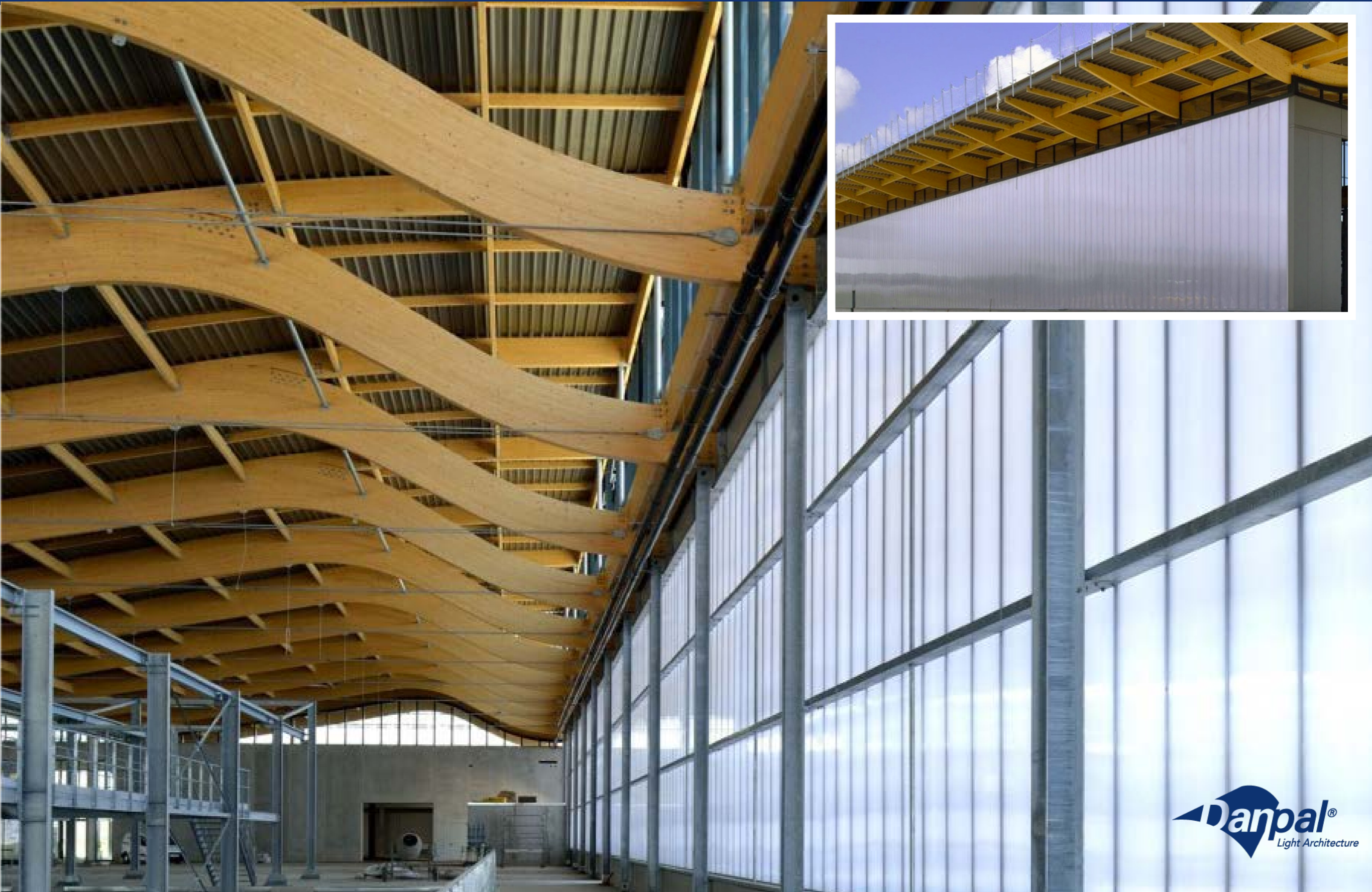

Ice Ring, France





Industrial Building ,Atelier d'Architecture Sylvain GUITTET, France



Industrial Building Architect: Koessler, France



Sport Complex, Agence Didier Richard, France



Gymnasium, Carril architects, France



Retail Shop, Architect: Cabinet Besuelle & Salley, France



Sport Complex, Architecten: Van Wassenhove, Belgium



Industrial ,Architect: Busato Maxima, France

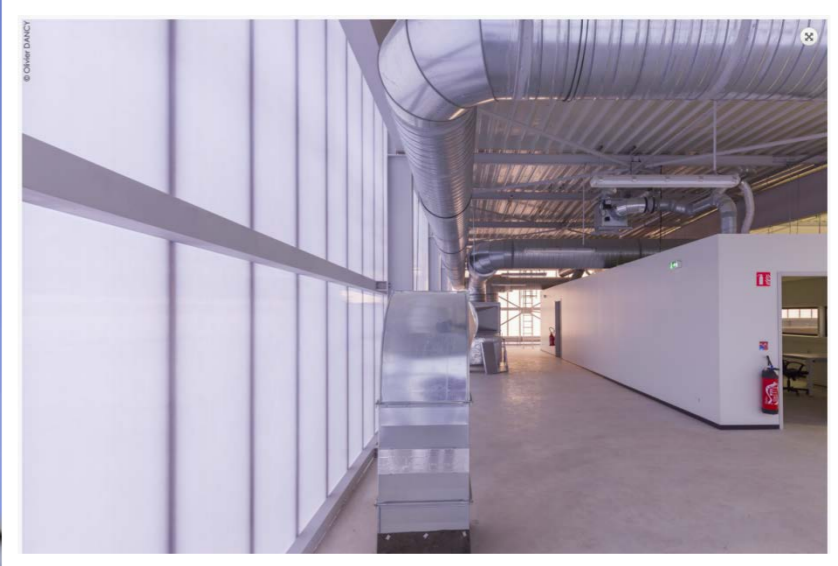

Sport center , Axi Architecture (77), France





Office and Industrial complex , France



Sport Club, Architect: Mme Doche, Hôtel de ville, Le Mans, France



Gymnasium, Architect: Matte Devaux Rousseau, France



Hospital, Spain



Blum logistic center, Architect Tektura Sp Poland



Sign Your Signature With Light



[www.danpal.com](http://www.danpal.com)